

# SHIMANO

## TALICA S A-RB

## TAC-25II

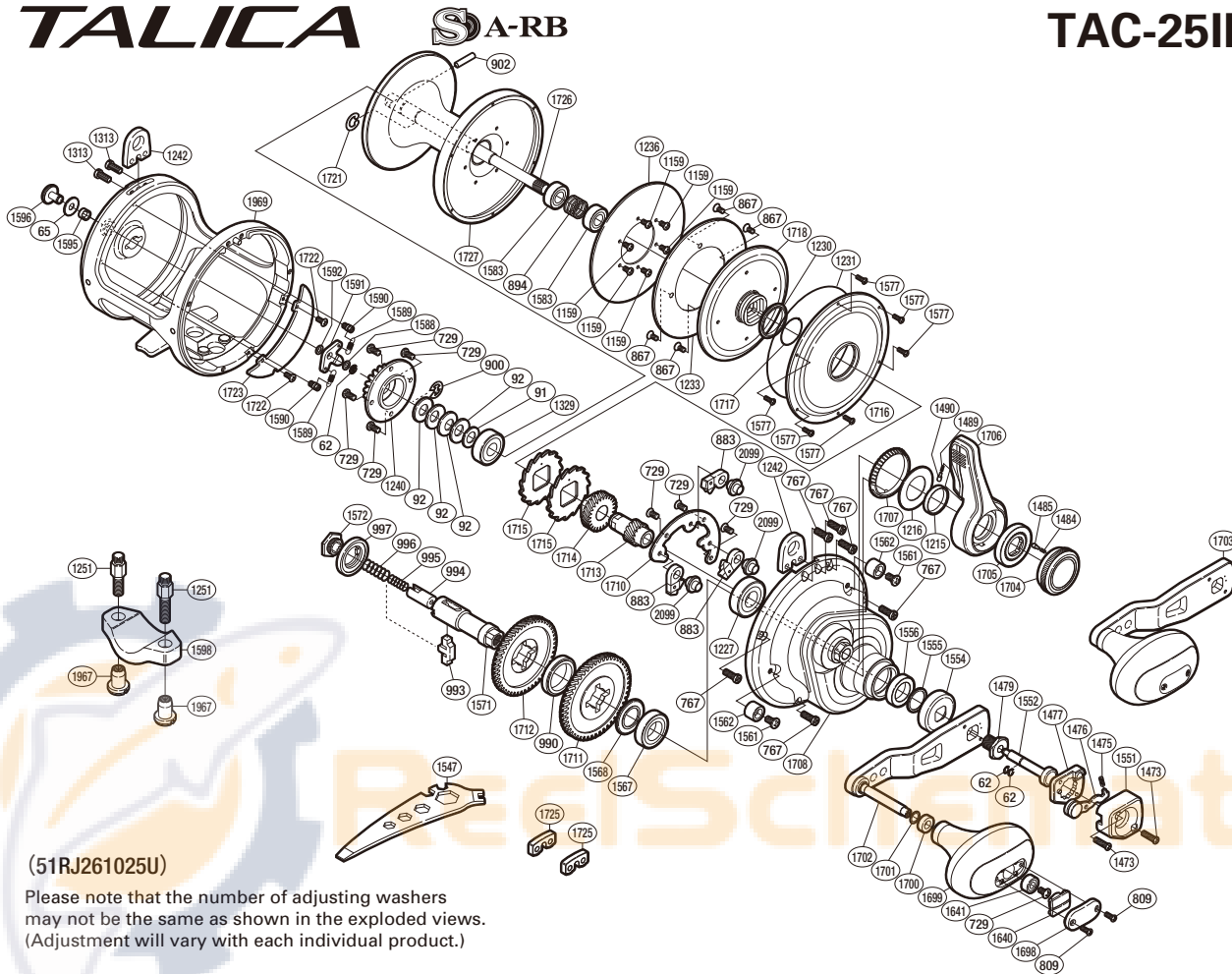

(51RJ261025U)

Please note that the number of adjusting washers may not be the same as shown in the exploded views. (Adjustment will vary with each individual product.)

| Part No. | Description             | Part No. | Description            | Part No. | Description                  |
|----------|-------------------------|----------|------------------------|----------|------------------------------|
| TGT0062  | E Lock                  | TGT1476  | Slide Plate            | TGT1701  | Washer                       |
| TGT0065  | Spacer                  | TGT1477  | Handle Bolt Plate      | TGT1702  | Handle Shank Assembly        |
| TGT0091  | Bearing Thrust Washer   | TGT1479  | Handle Bolt            | TGT1703  | Handle Assembly              |
| TGT0092  | Coned Disc Spring       | TGT1484  | Click Spring           | TGT1704  | Pre-Program Dial             |
| TGT0729  | Screw                   | TGT1485  | Click Pin              | TGT1705  | Lever Shaft Body             |
| TGT0767  | Screw                   | TGT1489  | Lever Click Shoe       | TGT1706  | Drag Control Lever           |
| TGT0809  | Screw                   | TGT1490  | Lever Click            | TGT1707  | Lever Click Gear             |
| TGT0867  | Screw                   | TGT1551  | Push Button Shield     | TGT1708  | Right Side Plate             |
| TGT0883  | Anti-Reverse Pawl       | TGT1552  | Push Low Button Shaft  | TGT1710  | Anti-Reverse Pawl Keeper     |
| TGT0894  | Pressure Release Spring | TGT1554  | Drive Shaft Shield     | TGT1711  | Drive Gear A                 |
| TGT0900  | E Lock                  | TGT1555  | Washer                 | TGT1712  | Drive Gear B                 |
| TGT0902  | Cross Pin               | TGT1556  | Drive Gear Bushing     | TGT1713  | Pinion Gear A                |
| TGT0990  | Friction Washer         | TGT1561  | Screw                  | TGT1714  | Pinion Gear B                |
| TGT0993  | Gear Select Cross Bar   | TGT1562  | Bolt Shield            | TGT1715  | Anti-Reverse Ratchet         |
| TGT0994  | Cross Bar Stop          | TGT1567  | Ball Bearing           | TGT1716  | Cooling Shield               |
| TGT0995  | Drive Shaft Spring B    | TGT1568  | Drive Gear Washer      | TGT1717  | Pinion Guard Support         |
| TGT0996  | Drive Shaft Spring      | TGT1571  | Drive Shaft            | TGT1718  | Pinion Guard                 |
| TGT0997  | Friction Washer         | TGT1572  | Drive Shaft Screw      | TGT1721  | C Lock                       |
| TGT1159  | Screw                   | TGT1577  | Screw                  | TGT1722  | Screw                        |
| TGT1215  | Lever Thrust Ring       | TGT1583  | Ball Bearing           | TGT1723  | Set Plate                    |
| TGT1216  | Washer                  | TGT1588  | Spacer                 | TGT1726  | Spool Shaft                  |
| TGT1227  | Ball Bearing            | TGT1589  | Click Pawl Spring      | TGT1727  | Spool                        |
| TGT1230  | Waterproof Ring         | TGT1590  | Click Spring Shaft     | TGT1969  | One-Piece Frame              |
| TGT1231  | O Ring                  | TGT1591  | Click Pawl             | TGT2099  | Anti-Reverse Pawl Pin        |
| TGT1233  | Drag Plate              | TGT1592  | Spacer                 |          |                              |
| TGT1236  | Drag Washer             | TGT1595  | Click Switch Cam       |          |                              |
| TGT1239  | Ball Bearing            | TGT1596  | Click Button           | TGT1251  | Rod Clamp Bolt (accessory)   |
| TGT1240  | Click Gear Support      | TGT1640  | Handle Knob Seal       | TGT1598  | Rod Clamp (accessory)        |
| TGT1242  | Harness Lug             | TGT1641  | Ball Bearing           | TGT1967  | Rod Clamp Nut (accessory)    |
| TGT1313  | Screw                   | TGT1698  | Handle Knob I.D. Plate |          |                              |
| TGT1473  | Screw                   | TGT1699  | Handle Knob            | TGT1547  | Wrench (accessory)           |
| TGT1475  | Slide Plate Spring      | TGT1700  | Handle Knob Bushing    | TGT1725  | Harness Lug Plug (accessory) |